

## SPRING ALIGNMENT DOWELS/BUSHINGS

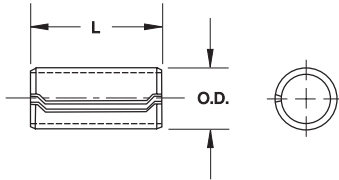

**Dowel bushings** are used to locate components in conjunction with bolts which pass through the inside of the bushing after it has been installed. Separate holes for locating pins are eliminated. The hardened bushings also absorb shear loads, isolating the bolts from these forces.

**Spring alignment dowels** are used to accurately locate components with respect to each other. They are formed around arbors to assure roundness. It is recommended that one half the hole tolerance be used for the fixed location of the dowel and one half for the hole in the mating part.



MATERIAL	FINISH	HARDNESS	INSPECTION METHODS
<b>B</b> Carbon Steel AISI 1070-1080 DIN 17722 CK67-75 BS 1449 CS70-80	<b>K</b> Plain, Oiled <b>T</b> Zinc Plated <b>R</b> Phosphated, Oiled	HV 420-545	<b>O.D.</b> - Micrometer <b>Length</b> - Caliper

The chamfer on dowel bushings and spring dowels is designed to facilitate insertion into minimum specified holes.

### Series DB100 - Dowel Bushings

INCH	Nominal Bolt Diameter	Tolerance Range for Holes		O.D.		Wall Thickness	Min. Single Shear	Length							
		Min.	Max.	Min.	Max.			.375 3/8	.500 1/2	.750 3/4	1.000 1	1.250 1-1/4	1.500 1-1/2	1.750 1-3/4	
	#10	.250	.255	.260	.270	.022	1,660 lbs.								
	.250 1/4	.313	.318	.323	.333	.028	2,670 lbs.								
	.312 5/16	.391	.396	.401	.411	.035	4,200 lbs.								
	.375 3/8	.469	.474	.479	.489	.042	6,070 lbs.								
	.500 1/2	.625	.630	.635	.645	.057	11,050 lbs.	LENGTH TOLERANCE + .000" - .030"							
	.625 5/8	.781	.786	.791	.801	.070	16,500 lbs.								
	.750 3/4	.932	.937	.942	.952	.083	23,300 lbs.								

METRIC	Nominal Bolt Diameter	Tolerance Range for Holes		O.D.		Wall Thickness	Minimum Single Shear	Length							
		Min.	Max.	Min.	Max.			10mm	12mm	20mm	25mm	30mm	35mm	40mm	
	5mm	6.35	6.48	6.60	6.86	0.56	7.4 kN								
	6mm	7.67	7.80	7.92	8.18	0.71	11.4 kN								
	8mm	9.93	10.06	10.18	10.44	0.89	18.7 kN								
	10mm	12.50	12.63	12.75	13.01	1.07	28.5 kN								
	12mm	15.09	15.22	15.34	15.60	1.45	46.5 kN								
	14mm	17.40	17.55	17.65	17.90	1.55	56.1 kN	LENGTH TOLERANCE + 0.0mm - 1.0mm							
	16mm	19.85	19.95	20.10	20.35	1.78	73.5 kN								

### Series SD200 - Spring Dowels

INCH	Nominal Dowel Diameter	Tolerance Range for Holes		O.D.		Wall Thickness	Minimum Single Shear	Length						
		Min.	Max.	Min.	Max.			.375 3/8	.500 1/2	.750 3/4	1.000 1	1.250 1-1/4	1.500 1-1/2	
	.250 1/4	.250	.255	.260	.270	.022	1,660 lbs.							
	.312 5/16	.313	.318	.323	.333	.028	2,670 lbs.							
	.375 3/8	.375	.380	.385	.395	.035	4,000 lbs.							
	.500 1/2	.500	.505	.510	.520	.042	6,530 lbs.	LENGTH TOLERANCE + .000" - .030"						
	.625 5/8	.625	.630	.635	.645	.057	11,050 lbs.							

METRIC	Nominal Dowel Diameter	Tolerance Range for Holes		O.D.		Wall Thickness	Minimum Single Shear	Length						
		Min.	Max.	Min.	Max.			10mm	12mm	20mm	25mm	30mm	35mm	
	6mm	6	6.13	6.25	6.5	0.56	6.9 kN							
	8mm	8	8.13	8.25	8.5	0.71	11.9 kN							
	10mm	10	10.13	10.25	10.5	0.89	18.9 kN							
	12mm	12	12.13	12.25	12.5	1.07	27.2 kN	LENGTH TOLERANCE + 0.0mm - 1.0mm						
	16mm	16	16.13	16.25	16.5	1.45	49.6 kN							

Standard Lengths

Note: .750" size does not require a staggered seam pattern to prevent interlocking. Larger and special diameters are available upon request.

Part Number: Product Type, Size x Length, Material, Finish, Series

Examples: BUSH .250 x .500 BK DB100    BUSH 10 x 20 BT DB100    BUSH .500 x 1.250 BK SD200    BUSH 10 x 20 BR SD200

# SPIROL®

Innovative fastening solutions.  
Lower assembly costs.



## Challenge Us!

**SPIROL** Application Engineers will review your application needs and work with your design team to recommend the best solution. One way to start the process is to visit our **Optimal Application Engineering** portal at [www.SPIROL.com](http://www.SPIROL.com).

**U.S.A. Spirol International Corporation**  
30 Rock Avenue  
Danielson, Connecticut 06239  
Tel. +1 (1) 860.774.8571  
Fax. +1 (1) 860.774.2048

**Spirol West Inc.**  
1950 Compton Avenue, Unit 111  
Corona, California 92881-6471  
Tel. +1 (1) 951.273.5900  
Fax. +1 (1) 951.273.5907

**Spirol International Corporation  
Shim Division**  
321 Remington Road  
Stow, Ohio 44224  
Tel. +1 (1) 330.920.3655  
Fax. +1 (1) 330.920.3659

**Spirol Distribution**  
(For Distributor Customers)  
30 Rock Avenue  
Danielson, Connecticut 06239  
Tel. +1 (1) 860.774.8571  
Fax. +1 (1) 860.774.0487

**Canada Spirol Industries, Ltd.**  
3103 St. Etienne Boulevard  
Windsor, Ontario  
Canada N8W 5B1  
Tel. +1 (1) 519.974.3334  
Fax. +1 (1) 519.974.6550

**Mexico Spirol México, S.A. de C.V.**  
Carretera a Laredo KM 16.5 Interior E  
Col. Moisés Saenz  
Apodaca, N.L. 66613 México  
ó Apdo. Postal 151 de Apodaca, N.L.  
Tel. +52 (01) 81 8385 4390  
Fax. +52 (01) 81 8385 4391

**Europe Spirol Industries, Ltd.**  
Princewood Road  
Corby, Northants  
England NN17 4ET  
Tel. +44 (0) 1536 444800  
Fax. +44 (0) 1536 203415  
(UK Distributors: Tel. 0800 3890034)

**Spirol SAS**  
Rue Henri Rol Tanguy  
Z.A. Les Naux  
51450 Bétheny - Reims  
France  
Tel. +33 (0) 3 26 36 31 42  
Fax. +33 (0) 3 26 09 19 76

**Spirol GmbH**  
Briener Strasse 9  
80333 Munich  
Germany  
Tel. +49 (0) 931 454 670 74  
Fax. +49 (0) 931 454 670 75

**Asia Pacific Spirol International Engineered  
Fastener Trading Co. Ltd.**  
No. 11 Xi Ya Rd. North  
Section A, 1F, Building 14  
Wai Gao Qiao Free Trade Zone  
Shanghai, China 200131  
Tel. +86 (0) 21 5046-1451/1452  
Fax. +86 (0) 21 5046-1540

e-mail: [info@spirol.com](mailto:info@spirol.com)

[www.SPIROL.com](http://www.SPIROL.com)